

# Series R: UVC Upper Room Linear Recessed Fixture

## Installation and Operating Instructions



EPA Est. 96318-WA-1

### CONGRATULATIONS

You’ve purchased a Series R UVC Upper Room Linear Recessed Fixture that will help clean the air in your facility.

Please read these instructions thoroughly before operating the fixture. If you have any questions, please contact our Customer Experience team at 425.595.6330, or [support@safeology.com](mailto:support@safeology.com).

### APPLICATION

These instructions apply only to Upper Room Linear Recessed Fixtures manufactured by Electric Mirror and distributed under the brand name Safeology. The product may be referred to as a “fixture” throughout these instructions.

### TABLE OF CONTENTS

I. REVIEW AND FOLLOW IMPORTANT SAFETY INSTRUCTIONS.....	2
II. UNPACK YOUR UPPER ROOM LINEAR RECESSED FIXTURE.....	4
III. INSTALLATION NOTES.....	4
IV. PREPARE THE ELECTRICAL.....	4
VI. INSTALL LAMPS.....	9
VII. OPERATING INSTRUCTIONS .....	11
VIII. CARE AND CLEANING INSTRUCTIONS .....	12



# Series R: UVC Upper Room Linear Recessed Fixture

## Installation and Operating Instructions



### I. REVIEW AND FOLLOW IMPORTANT SAFETY INSTRUCTIONS



#### A. Read first.

1. READ AND FOLLOW ALL SAFETY INSTRUCTIONS
2. WARNING: RISK OF ELECTRICAL SHOCK
3. ALWAYS USE A GROUNDED OUTLET
4. SAVE THESE INSTRUCTIONS

#### B. Take caution: UVC radiation poses a potential hazard.

1. Never look directly at lamp while on, as UVC radiation can cause severe eye and skin damage.
2. Always turn fixture off before lamp replacement.
3. When replacing lamps, replace them only with the lamps for which the equipment is marked and intended.

#### C. Follow important safeguards.

1. This equipment is designed for use with germicidal UVC radiation sources and must be operated in compliance with these Instructions to prevent risk of personal injury from UVC radiation.
2. Turn off all power before servicing.
3. Maintenance and servicing of this UVC equipment must be performed by authorized personnel.
4. The use of accessory equipment not recommended by the manufacturer may cause an unsafe condition.
5. Do not use this equipment for other than intended use.

#### D. Read operating instructions prior to operating the fixture.

1. Operate the fixture according to these instructions.
2. Failure to follow these instructions voids the warranty.

#### E. To be installed by qualified electrician.

1. Follow national electric code during installation.
2. Turn off power at breaker before installation or servicing.
3. Be careful to avoid risk of electrical shock.
4. Ensure fixture is grounded.
5. Install per manufacturer's stated guidelines – see section V:A.

#### F. Mercury lamp disposal and clean up.

1. If lamp breaks, follow instructions found here: <https://www.epa.gov/cfl/cleaning-broken-cfl>.
2. See the following website for disposal information: <https://www.epa.gov/cfl/recycling-and-disposal-cfls-and-other-bulbs-contain-mercury#whererecycle>.

## ATTENTION RISQUE DE RAYONNEMENT UVC

### CONSIGNES DE SÉCURITÉ IMPORTANTES

1. LISEZ ET SUIVEZ TOUTES LES CONSIGNES DE SÉCURITÉ
2. AVERTISSEMENT: RISQUE DE CHOC ÉLECTRIQUE
3. UTILISEZ TOUJOURS UNE PRISE MISE À LA TERRE
4. COUPEZ L'ALIMENTATION AU DISJONCTEUR AVANT L'INSTALLATION OU L'ENTRETIEN
5. CONSERVEZ CES INSTRUCTIONS

### GARANTIES IMPORTANTES

Lors de l'utilisation d'équipements électriques, des précautions de sécurité de base doivent toujours être suivies, notamment les suivantes:

### LISEZ ET SUIVEZ TOUTES LES CONSIGNES DE SÉCURITÉ

1. Cet équipement est conçu pour être utilisé avec des sources de rayonnement UV germicides et doit être utilisé conformément à ces instructions pour éviter tout risque de blessure par rayonnement UV.
2. La maintenance et l'entretien de cet équipement générateur d'UV doivent être effectués par du personnel autorisé. Toujours débrancher de l'alimentation avant l'entretien
3. Lors du remplacement des lampes, remplacez-les uniquement par les lampes pour lesquelles l'équipement est marqué et conçu.
4. L'utilisation d'équipements accessoires non recommandés par le fabricant peut entraîner une situation dangereuse.
5. N'utilisez pas cet équipement à d'autres fins que celles pour lesquelles il a été conçu.

### CONSERVEZ CES INSTRUCTIONS

Le rayonnement UVC peut provoquer de graves lésions oculaires et cutanées. Ne regardez jamais directement la lampe lorsqu'elle est allumée. Éteignez toujours le produit avant de remplacer la lampe. L'appareil doit être installé et utilisé en stricte conformité avec ces instructions. Appareil fonctionnant selon les directives du fabricant.

# Series R: UVC Upper Room Linear Recessed Fixture

## Installation and Operating Instructions



## II. UNPACK YOUR UPPER ROOM LINEAR RECESSED FIXTURE

### A. Verify the contents.

1. Unpack the box, identify, and verify all contents prior to installation. In general, your fixture will include the following:

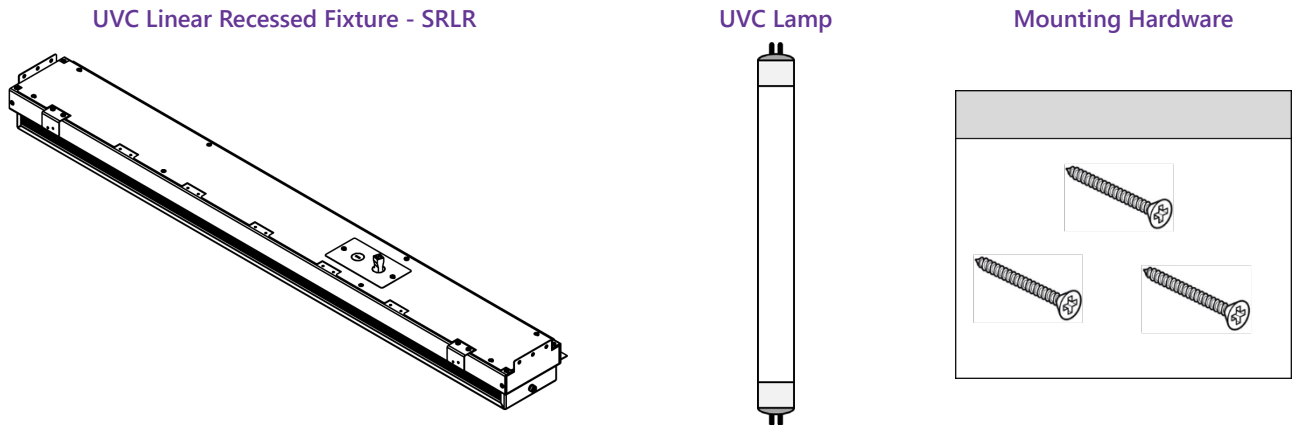

Note: Ceiling security cable not included.

## III. INSTALLATION NOTES

- A. Ceiling height locations – See section V.A below.**
- B. Wall treatment selection may alter UVC reflection – avoid applications with high reflectivity such as polished metal or UV reflective paint.**
- C. T-Grid ceiling requirements.**
  1. Use with T-Grid ceilings manufactured and installed in accordance with ASTM C635 & ASTM C636.
  2. Compatible with either 9/16" or 15/16" face profiles, with a height no larger than 1 11/16".

## IV. PREPARE THE ELECTRICAL

- A. Ensure all power is off to the area by turning off the breaker.**
- B. Fixture should be controlled by wall switch.**
- C. Run wiring through 1/2" flexible conduit to knockout location on top of fixture.**

# Series R: UVC Upper Room Linear Recessed Fixture

## Installation and Operating Instructions



### V. INSTALL THE FIXTURE

#### A. Determine location where fixture will be installed.

1. Placement of fixture is critical for safe and effective operation.
  - a. Mount the fixture in an area with good air circulation for best results.
  - b. Follow installation instructions carefully.
  - c. Consider any ceiling reflection of UVC.
  - d. Survey the room immediately after installation with a UVC detection meter to ensure safe level of UVC in occupied spaces.
2. Ceiling height locations.
  - a. Identify the fixture purchased:

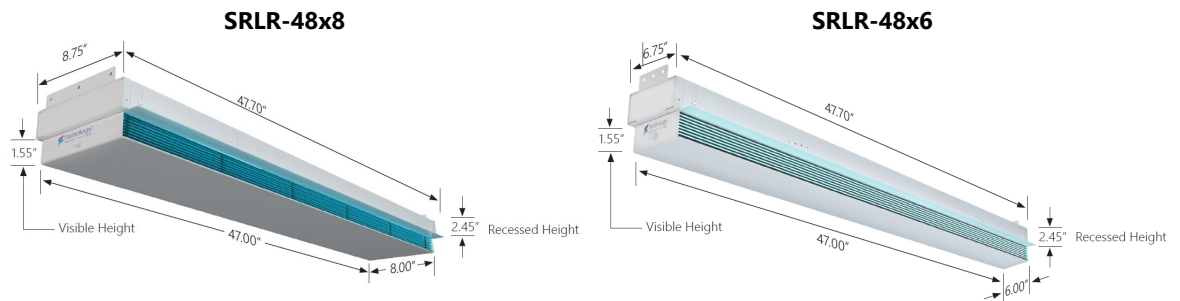

- b. Identify appropriate installation height using the table and diagram below (diagram not to scale). Measure installation height from the top of the finished floor to the bottom of the fixture.

Fixture	Minimum Installation Height (A)	Maximum distance fixture can be mounted from parallel wall (B)*	Minimum separation between fixtures (end to end) (C)*
SRLR-48x8	9' 8"	65' 0"	16' 0"
SRLR-48x6	7' 10"	10' 6"	20' 0"
SRLR-48x6	8' 4"	23' 0"	12' 0"

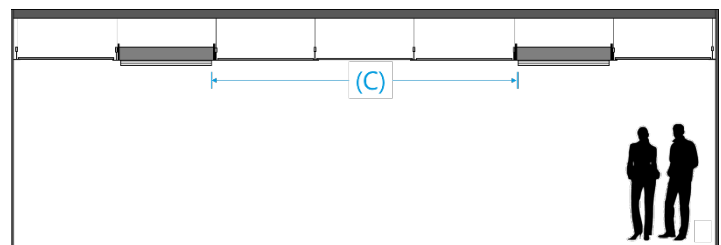
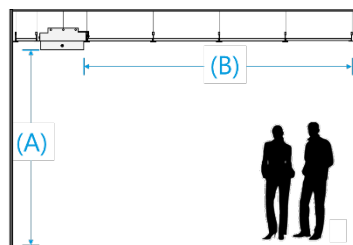

\* These distances are calculated based on the installation heights (A). Different heights may require different separation distances.

# Series R: UVC Upper Room Linear Recessed Fixture

## Installation and Operating Instructions



3. Once desired location is identified.
  - a. Remove ceiling tile.
  - b. Remove adjacent tile for access to T-Grid mounting brackets.

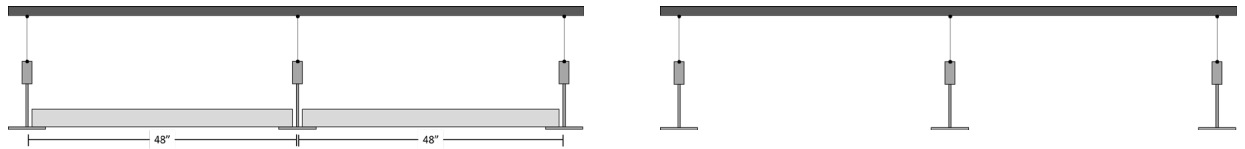

### B. If desired, add in additional T in the grid to support the ceiling tile.

1. Skip to V.D if additional T's are not being installed.
2. Install an additional T into the grid system. The T should be installed center to center at the following distances.
  - a. SRLR-48X8 – install 9" from originating T.
  - b. SRLR-48X6 – install 7" from originating T.

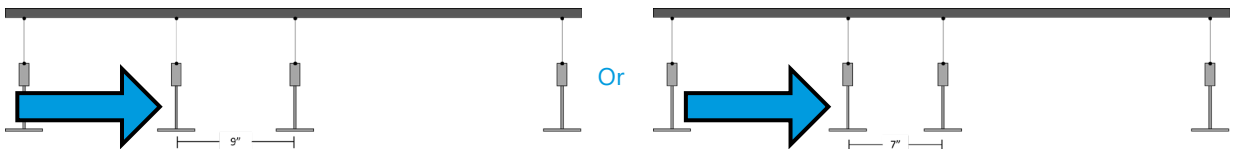

3. Adjust bracket on the side of the fixture to ensure the fixture hangs level in the grid.
  - a. Adjustable in 1/16" increments.
  - b. Fixture generally installed out of the box with the bracket at the position marked with a "\*".
  - c. Move the bracket to the position marked 'T' when using an additional T in the grid.
  - d. Use unmarked holes when ceiling tiles extend below the T-Grid level.

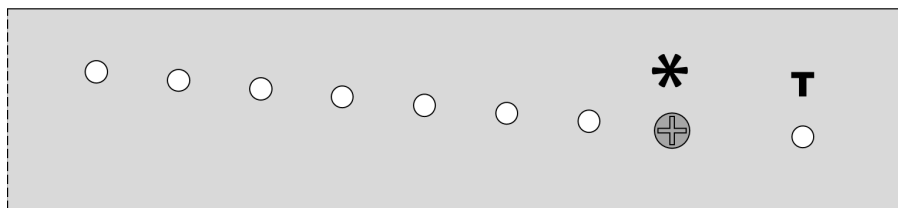

# Series R: UVC Upper Room Linear Recessed Fixture

## Installation and Operating Instructions



### C. Hang the fixture.

1. Maneuver the fixture into the ceiling by lifting first one end in, then lifting in the other end before dropping the fixture into place. The fixture should be supported by T-Grids on 3 sides.

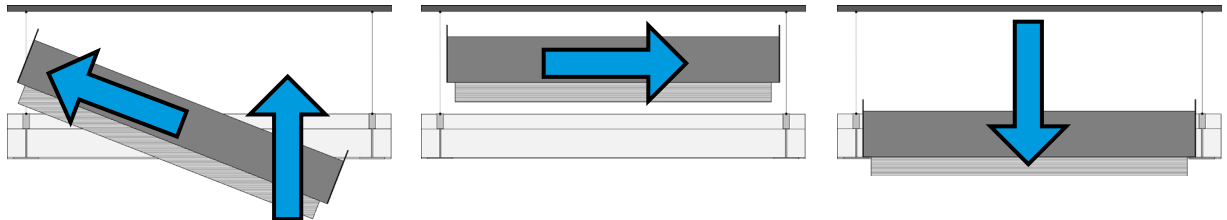

2. Use the adjustable screw to secure the fixture to the T-Grid. Fixture should rest on the T-Grid.

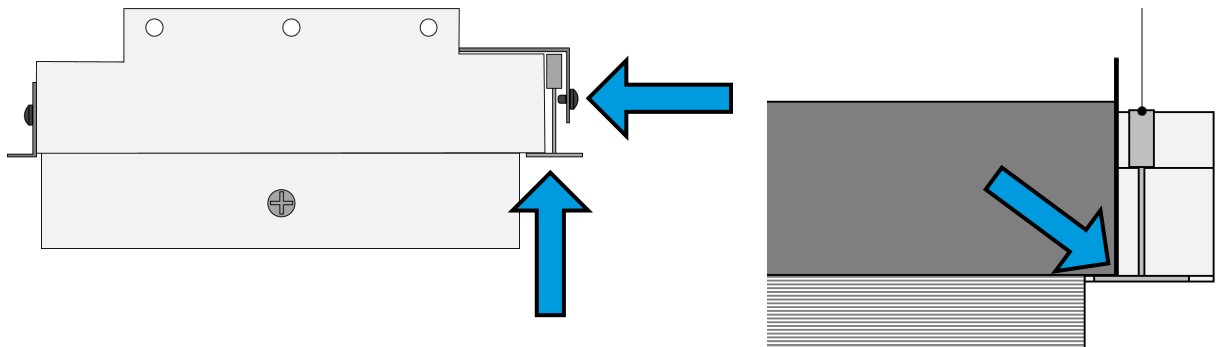

3. Secure fixture to ceiling with hanger wire if desired. Holes are provided in the top of the fixture at the short ends. Hardware not included.
4. If necessary, the brackets on the fixture can be moved to avoid interference or obstacles.

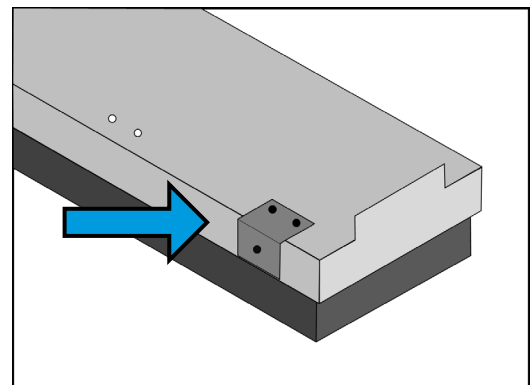
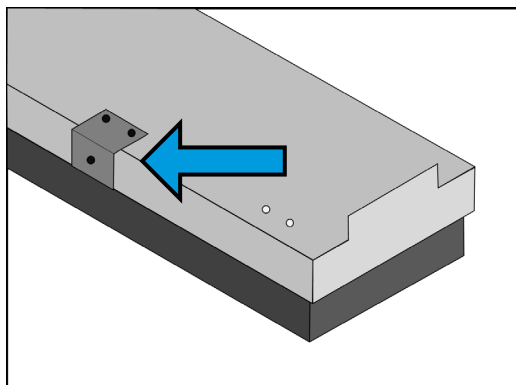

## Series R: UVC Upper Room Linear Recessed Fixture

### Installation and Operating Instructions



#### D. Connect the electrical.

1. Remove two screws from the electrical cover on the top of the fixture.

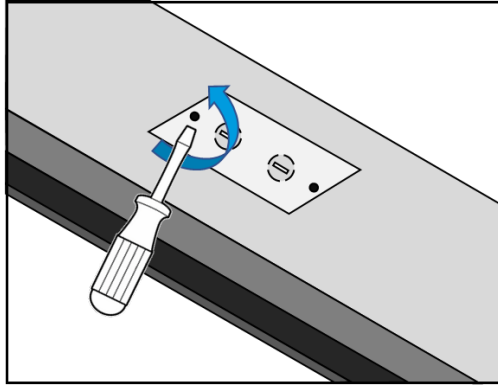

2. Connect flexible conduit to fixture and make wiring connections.
  - a. Use appropriate termination fitting for 1/2" flexible conduit.
  - b. Strip ends of wire 7/16".
  - c. Insert ground wire into green wire port – FIXTURE MUST BE GROUNDED.
  - d. Insert hot wire into port 1 (black) of luminaire disconnect.
  - e. Insert neutral wire into port 2 (white) of luminaire disconnect.
3. Secure the electrical cover by reinserting both screws.

#### E. Re-install the ceiling tile.

1. Measure opening and cut appropriately sized tile to fill remaining space and install.
2. Support the cut down ceiling tile by one of the following:
  - a. The bracket on the side of the fixture or

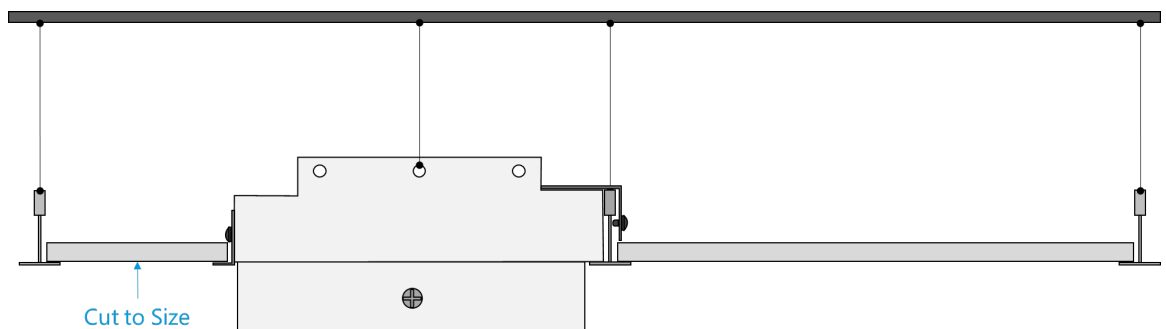



# Series R: UVC Upper Room Linear Recessed Fixture

## Installation and Operating Instructions



- b. Additional T installed in the grid.

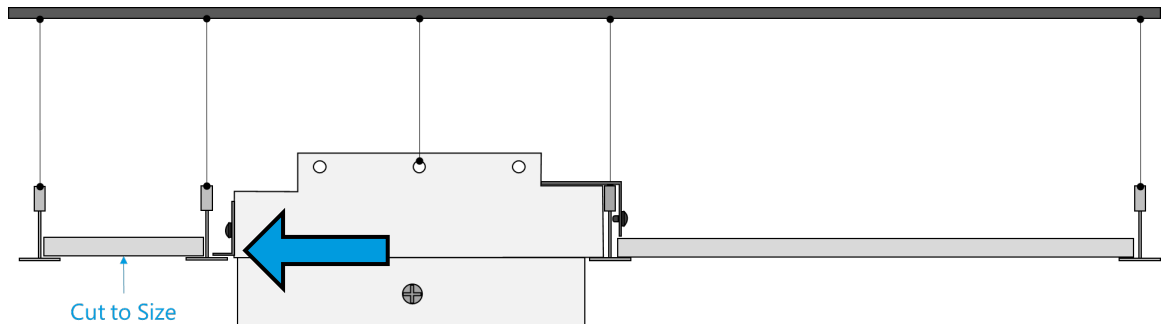

## VI. INSTALL LAMPS

### A. Remove the cover.

1. Loosen screws at both short ends of the fixture and set aside.

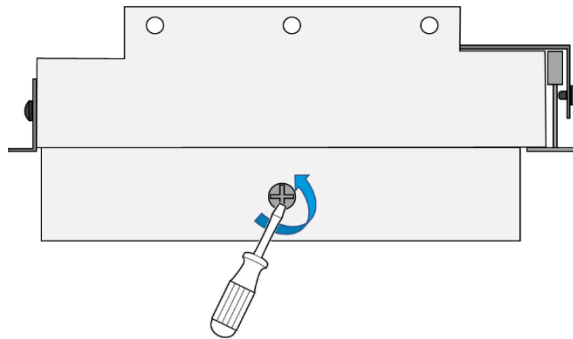

2. Remove cover and set aside. Cover is supported by magnets to the main fixture.

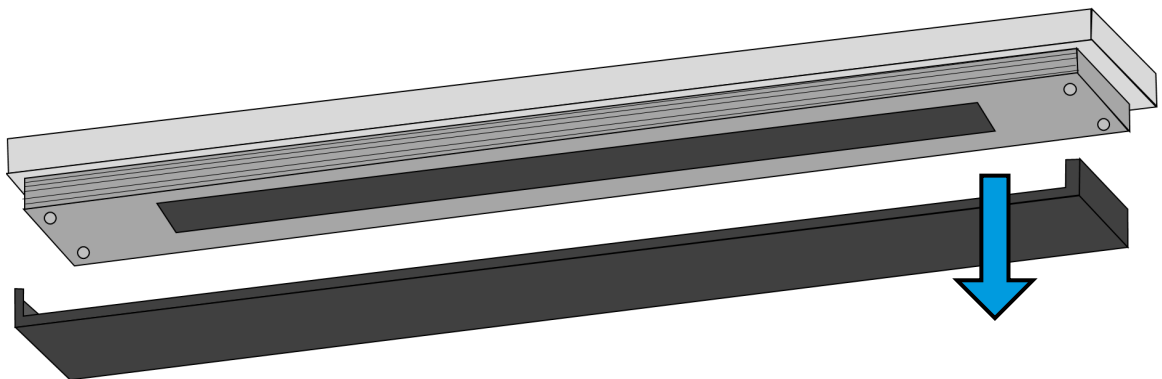

## Series R: UVC Upper Room Linear Recessed Fixture

### Installation and Operating Instructions



#### B. Install the lamp.

1. Insert pins of the lamp into the holder on both ends on the underside of the fixture, rotating the lamp 90° to secure.

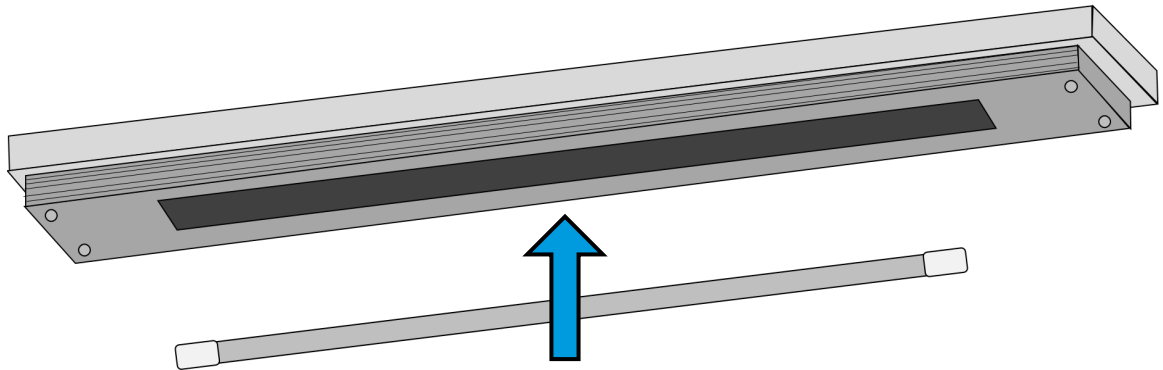

#### C. Close the fixture.

1. Replace the lamp cover.
2. Replace the screws on the short end of the fixture.

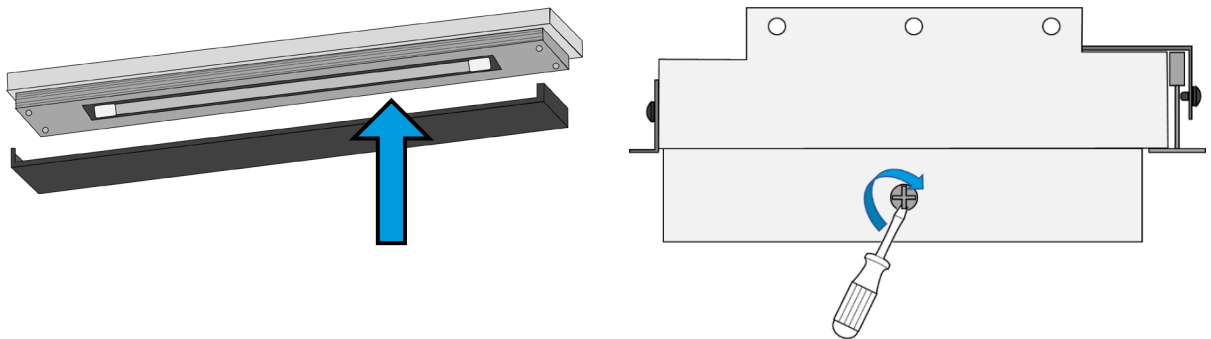

## VII. OPERATING INSTRUCTIONS

### A. Fixture is operated by on/off wall switch.

### B. Replacing the lamps.

1. Turn off the power.
  - a. Turn the master power switch to off. Fixture will remain on until turned off.
  - b. Fixture also has an internal safety switch that will turn off lamp if lamp cover is removed.
2. Remove lamp.
  - a. Open fixture as described in VI.A.
  - b. Rotate lamp 90° and remove.
  - c. Install new lamp via step VI.B-above.

### C. Ensure UVC lamp is operational.

1. Always ensure UVC lamp is operational after device has been switched off.
2. UVC lamp will emit a small amount of light in the visible spectrum.
3. To verify the fixture is on:
  - a. Look up towards fixture for soft blue glow.
  - b. Never look directly at lamp while on.

### VIII. CARE AND CLEANING INSTRUCTIONS

Failure to follow the instructions below will void the warranty.

- A. Always turn off power at circuit breaker prior to servicing.**
- B. Use soft, grit-free, and lint-free cloths to reduce the chance of scratching.**
- C. Never spray liquid directly onto the fixture.**
  - 1. Instead, apply it directly to the cloth, then wipe.
  - 2. Ensure everything is thoroughly dry.
- D. Clean and replace lamps at recommended intervals**
  - 1. Clean every 3 months using alcohol.
  - 2. Replace lamps every year or 9,000 hours of operation.
    - a. Lamp must match specification listed on label in housing.
    - b. See above for installation instructions.
- E. Clean louvers at recommended intervals.**
  - 1. Dust every 3 months.
  - 2. Use dry duster or vacuum.